

**COLOURS**

MAIN BODY - 20 D 45 TRAFALGAR BLUE  
 LEGS - 20 D 45 TRALAGAR BLUE  
 CORNERS - 20 D 45 TRAFALGAR BLUE  
 FASCIA - 20 D 45 TRAFALGAR BLUE  
 DOOR - 20 D 45 TRAFALGAR BLUE

CEILING HEIGHT - 2235mm  
 EXTERNAL - 1.6mm 2 CORRY STEEL, WITH PAINT FINISH.  
 INTERNAL - WHITE CSM10 PREFINISHED PLYWOOD TO WALLS, CEILINGS TO BE WHITE V/FACED P/B.  
 WINDOWS - ALUMINIUM FRAMED SINGLE GLAZED  
 H/L - 560 x 300mm FULLY OPENING, OBSCURE GLAZED FITTED WITH WELDMESH GUARDS.  
 DOOR - STEEL c/w 5 LEVER LOCK.  
 INSULATION - 60mm TO WALLS & ROOF.

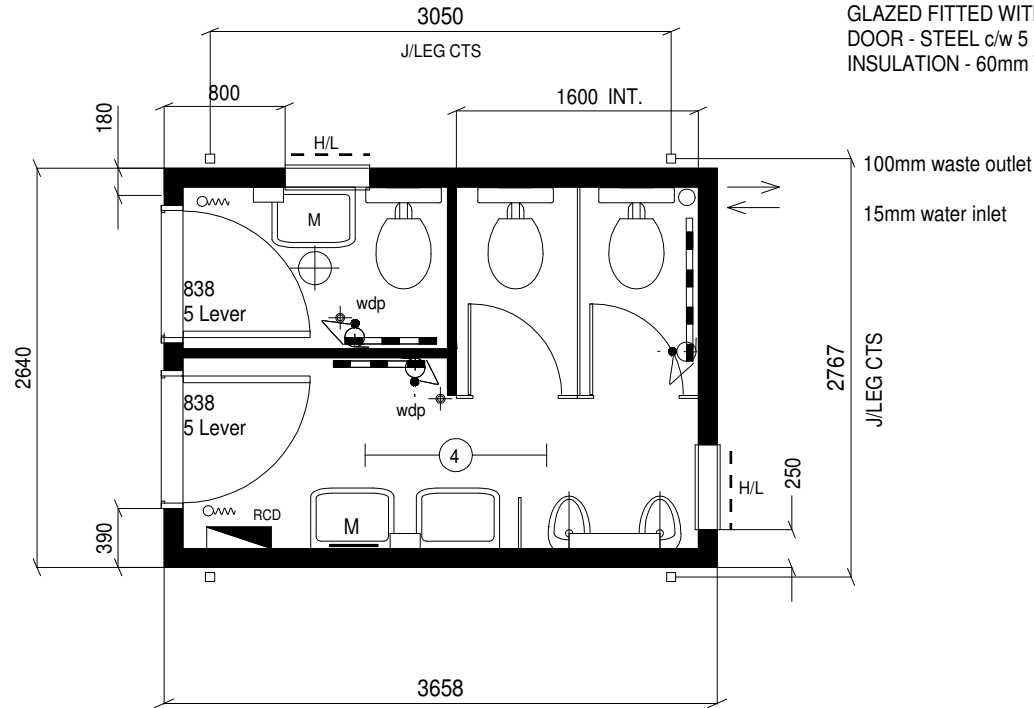

**PLAN LAYOUT**

FLOOR COVERING SHEET  
 VINYL COL. BLACK.

SKIRT - PVC SET ON TYPE  
 COVE - BROWN PLASTIC

***ISOLATOR SUBJECT  
 TO CONFIRMATION.***



Client  
 Title STANDARD 12' x 9' HIRE SPECIFICATION 2 + 1  
 TOILET SECURE STEEL UNIT - PLAN LAYOUT

Revisions	Drawn	MAH
A: ELECTRICS & NOTES AMENDED 2/11/99	Scale	1:50
B: INTERNAL WALL BOARD & FEMALE WHB AMEDNED 28/02/00	Date	OCT 99'
C: INTERNAL WALL BOARD AMEDNED 12/08/04 MAH	Drg No	50-25SS
D: COLOURS AMENDED TO ALL BLUE. 2004 MAH		